

6 5 4 3 2 1

REVISION					
ZONE	REV	DESCRIPTION	DATE	CHANGED BY	APPROVED
	2	UPDATE TEMPERATURE	10/29/2024	SLI	SXU

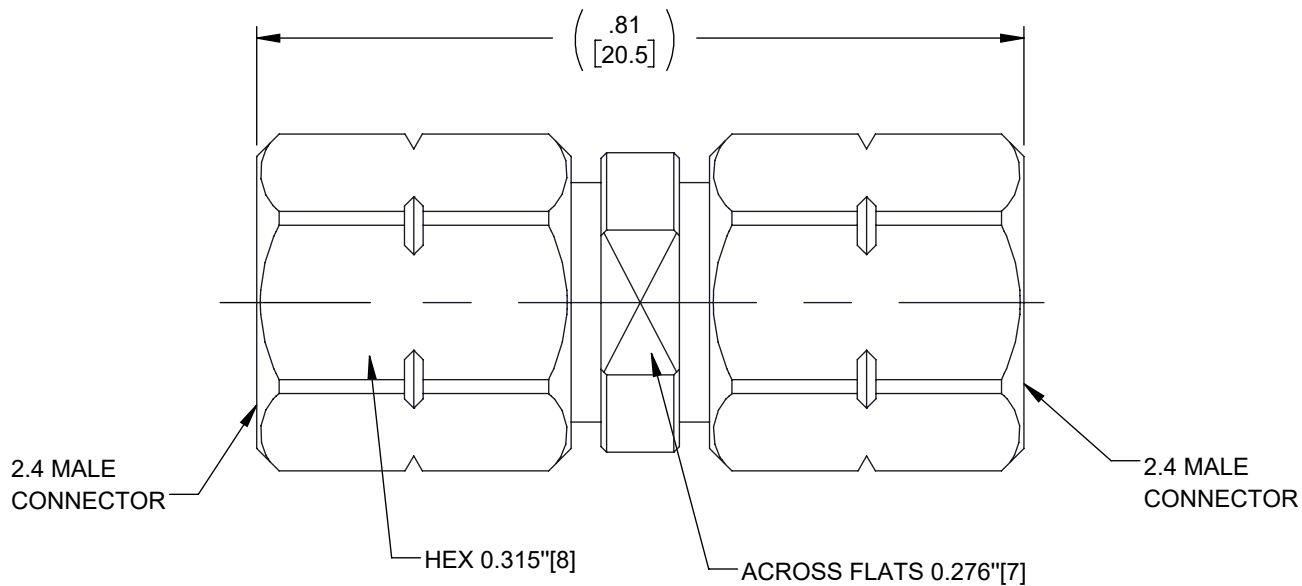

#### NOTES:

- 1. MATERIALS AND FINISHES:**  
BODY - STAINLESS STEEL, PASSIVATED  
OUTER CONTACT - STAINLESS STEEL, PASSIVATED  
INNER CONTACT - BERYLLIUM COPPER, GOLD PLATING  
INSULATOR - PEI
- 2. ELECTRICAL**  
IMPEDANCE: 50 OHM  
FREQUENCY RANGE: DC - 50 GHz  
VSWR: 1.35 MAX. @DC - 50 GHz  
INSERTION LOSS:  $0.1\sqrt{f(\text{GHz})}$  dB MAX.  
VOLTAGE RATING: 500 VRMS  
DIELECTRIC WITHSTANDING VOLTAGE: 2000 VRMS MIN.  
INSULATION RESISTANCE: 5000 MOHMS MIN.
- 3. MECHANICAL**  
DURABILITY: 1000 CYCLES MIN.  
TEMPERATURE RANGE: -55 TO +125°C  
COMPATIBLE WITH ALL STANDARD: IEC 61169-40

THE INFORMATION CONTAINED IN THIS DRAWING IS THE SOLE PROPERTY OF INFINITE ELECTRONICS, INC. ANY REPRODUCTION IN PART OR WHOLE WITHOUT THE WRITTEN PERMISSION OF INFINITE ELECTRONICS, INC. IS PROHIBITED.  
THESE COMMODITIES, TECHNOLOGY OR SOFTWARE WERE EXPORTED FROM THE UNITED STATES IN ACCORDANCE WITH THE EXPORT ADMINISTRATION REGULATIONS. DIVERSION CONTRARY TO U.S. LAW PROHIBITED.

UNLESS OTHERWISE SPECIFIED  
LEADING DIMENSIONS ARE INCHES  
DIMENSIONS IN [ ] ARE MILLIMETERS

**TOLERANCES:**  
.X = ±.2 [5] FRACTIONS  
.XX = ±.02 [.5] ± 1/32  
.XXX = ±.005 [.13] ANGLES ± 1°

**CABLE LENGTH TOLERANCES:**  
≤12 [305] = +1 [25] / -0  
>12 [305] ≤ 60 [1524] = +2 [51] / -0  
>60 [1524] ≤ 120 [3048] = +4 [102] / -0  
>120 [3048] ≤ 300 [7620] = +6 [152] / -0  
>300 [7620] = +5% / -0

ALL DIMENSIONS ARE FOR REFERENCE ONLY  
AND SUBJECT TO CHANGE WITHOUT NOTICE.



Website: [www.Pasternack.com](http://www.Pasternack.com)  
Phone: 1.866.727.8376 | 1.949.261.1920

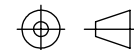

INTERPRET ALL DIMENSIONS AND  
TOLERANCES PER ASME Y14.5

SCALE	SHEET
NONE	1 OF 1

DESCRIPTION			
2.4 male to 2.4 male 50GHz Adapter			
SIZE	CAGE CODE	DRAWN BY	ITEM NO.
A	53919	SLI	PECCN004
			REV
			2