



## SMP Female to SMP Female Adapter 12.6mm Long Bullet

### TECHNICAL DATA SHEET

PE9776

#### SMP Female to SMP Female Adapter 12.6mm Long Bullet

##### Configuration

Connector 1	SMP Female
Impedance 1	50 Ohms
Connector Specification 1	MIL-STD-348A
Connector 2	SMP Female
Impedance 2	50 Ohms
Connector Specification 2	MIL-STD-348A
Adapter Design	Standard
Body Style	Straight

##### Electrical Specifications

Frequency Range, GHz	DC to 26.5
Maximum Operating Voltage, Volts	335
Dielectric Withstanding Voltage, Vrms	500

##### Frequency 1

Frequency, GHz	DC to 4
VSWR	1.08:1
Return Loss, dB	28
Insertion Loss, dB	0.2

##### Frequency 2

Frequency, GHz	4 to 12
VSWR	1.29:1
Return Loss, dB	18
Insertion Loss, dB	0.346

##### Frequency 3

Frequency, GHz	12 to 18
VSWR	1.43:1
Return Loss, dB	15
Insertion Loss, dB	0.424

##### Mechanical Specifications

##### Temperature

Operating Range, deg C	-65 to +155
------------------------	-------------

##### Size

Length, in [mm]	0.496 [12.6]
Width/Dia., in [mm]	0.135 [3.43]

Click the following link (or enter part number in "SEARCH" on website) to obtain additional part information including price, inventory and certifications: [SMP Female to SMP Female Adapter 12.6mm Long Bullet PE9776](#)

The information contained in this document is accurate to the best of our knowledge and representative of the part described herein. It may be necessary to make modifications to the part and/or the documentation of the part, in order to implement improvements. Pasternack reserves the right to make such changes as required. Unless otherwise stated, all specifications are nominal.





## SMP Female to SMP Female Adapter 12.6mm Long Bullet

### TECHNICAL DATA SHEET

PE9776

#### Connector 1

Type  
Inner Conductor Material and Plating  
Inner Conductor Plating Specification  
Body Material and Plating  
Body Plating Specification  
Dielectric Type

SMP Female  
Beryllium Copper, Gold  
6μ in. minimum  
Beryllium Copper, Gold  
6μ in. minimum  
PTFE

#### Connector 2

Type  
Inner Conductor Material and Plating  
Inner Conductor Plating Specification  
Body Material and Plating  
Body Plating Specification  
Dielectric Type

SMP Female  
Beryllium Copper, Gold  
6μ in. minimum  
Beryllium Copper, Gold  
6μ in. minimum  
PTFE

#### Compliance Certifications (visit [www.Pasternack.com](http://www.Pasternack.com) for current document)

RoHS Compliant

Yes

#### Plotted and Other Data

Notes:

Values at 25 °C, sea level

URL: <http://www.pasternack.com/smp-female-smp-female-straight-adapter-pe9776-p.aspx>

SMP Female to SMP Female Adapter 12.6mm Long Bullet from Pasternack Enterprises has same day shipment for domestic and International orders. Our RF, microwave and fiber optic products maintain a 99% availability and are part of the broadest selection in the industry.

The information contained in this document is accurate to the best of our knowledge and representative of the part described herein. It may be necessary to make modifications to the part and/or the documentation of the part, in order to implement improvements. Pasternack reserves the right to make such changes as required. Unless otherwise stated, all specifications are nominal.

PE9776 CAD Drawing  
SMP Female to SMP Female Adapter 12.6mm Long Bullet

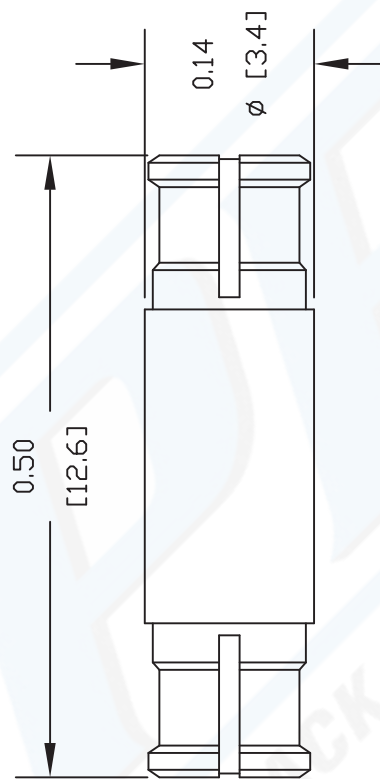

DWG TITLE

**PE9776**

NOTES:

1. UNLESS OTHERWISE SPECIFIED ALL DIMENSIONS ARE NOMINAL.
2. ALL SPECIFICATIONS ARE SUBJECT TO CHANGE WITHOUT NOTICE AT ANY TIME.
3. DIMENSIONS ARE IN INCHES [mm].

**PASTERNAK ENTERPRISES, INC.**

P.O. BOX 16759, IRVINE, CA 92623  
PHONE (949) 261-1920 FAX (949) 261-7451

WEB ADDRESS: [www.pasternack.com](http://www.pasternack.com)  
E-MAIL ADDRESS: [sales@pasternack.com](mailto:sales@pasternack.com)

**COAXIAL & FIBER OPTICS**



**PASTERNAK ENTERPRISES®**  
ESTABLISHED 1972

**FSCM NO. 53919**

CAD FILE 101306

SCALE N/A

SIZE A

127