



SSMC Jack to SSMC Jack Bulkhead Mount Adapter

RF Adapters Technical Data Sheet

PE91432

Configuration

- SSMC Jack Connector 1
- SSMC Jack Connector 2
- 50 Ohm
- Straight Body Geometry
- Bulkhead Mount Method

Features

- Max VSWR of 1.25:1 up to 4 GHz
- SSMC interface compliant with MIL-C-39012
- Contact plating according to MIL-G-45204
- Gold Plated Beryllium Copper Contact

Applications

- General Purpose Test
- Rack Mounted Equipment

Description

Pasternack's PE91432 SSMC jack to SSMC jack bulkhead adapter is part of our full line of RF components available for same-day shipping. Our SSMC to SSMC adapter has a jack to jack gender configuration. PE91432 SSMC jack to SSMC jack adapter operates to 4 GHz. The Pasternack RF adapter provides excellent VSWR of 1.25:1 maximum. This RF SSMC to SSMC bulkhead adapter allows designers to create external connections on their product enclosures, and can be used in a variety of other rack mount and panel mount applications.

RF adapters are often used to enable connections between two connector types that would otherwise not mate. Certain adapter configurations can also be used to protect connectors on expensive equipment where the number of connect/disconnect cycles is high. An RF, microwave or millimeter wave adapter is connected to the equipment, and the commonly changed connection is made with the adapter which can be easily replaced when it wears out after high usage; such adapters are referred to as connector savers. Pasternack also offers bulkhead, panel mount, hermetically sealed, reverse polarity, and isolated ground adapter varieties to serve all of your RF, microwave and millimeter wave needs.

Electrical Specifications

Description	Minimum	Typical	Maximum	Units
Frequency Range	DC		4	GHz
VSWR			1.25:1	

Electrical Specification Notes:
 Values at 25°C, sea level.

Mechanical Specifications

Size	
Length	0.623 in [15.82 mm]
Width	0.156 in [3.96 mm]
Weight	0.0065 lbs [2.95 g]

Click the following link (or enter part number in "SEARCH" on website) to obtain additional part information including price, inventory and certifications: [SSMC Jack to SSMC Jack Bulkhead Mount Adapter PE91432](#)



SSMC Jack to SSMC Jack Bulkhead Mount Adapter

RF Adapters Technical Data Sheet

PE91432

Description	Connector 1	Connector 2
Type	SSMC Jack	SSMC Jack
Polarity	Standard	Standard
Interface Specification	MIL-C-39012	MIL-C-39012

Material Specifications

Description	Connector 1		Connector 2	
	Material	Plating	Material	Plating
Type	SSMC Jack		SSMC Jack	
Contact	Beryllium Copper	Gold MIL-G-45204	Beryllium Copper	Gold MIL-G-45204
Insulation	PTFE		PTFE	
Outer Conductor	Brass	Nickel QQ-N-290	Brass	Nickel QQ-N-290

Environmental Specifications

Temperature

Operating Range -65 to +165 deg C

Compliance Certifications (see [product page](#) for current document)

Plotted and Other Data

Notes:

Click the following link (or enter part number in "SEARCH" on website) to obtain additional part information including price, inventory and certifications: [SSMC Jack to SSMC Jack Bulkhead Mount Adapter PE91432](#)



SSMC Jack to SSMC Jack Bulkhead Mount Adapter

RF Adapters Technical Data Sheet

PE91432

SSMC Jack to SSMC Jack Bulkhead Mount Adapter from Pasternack Enterprises has same day shipment for domestic and International orders. Our RF, microwave and millimeter wave products maintain a 99.4% availability and are part of the broadest selection in the industry.

Click the following link (or enter part number in "SEARCH" on website) to obtain additional part information including price, inventory and certifications: [SSMC Jack to SSMC Jack Bulkhead Mount Adapter PE91432](https://www.pasternack.com/ssmc-jack-ssmc-jack-straight-adapter-pe91432-p.aspx)

URL: <https://www.pasternack.com/ssmc-jack-ssmc-jack-straight-adapter-pe91432-p.aspx>

The information contained in this document is accurate to the best of our knowledge and representative of the part described herein. It may be necessary to make modifications to the part and/or the documentation of the part, in order to implement improvements. Pasternack reserves the right to make such changes as required. Unless otherwise stated, all specifications are nominal. Pasternack does not make any representation or warranty regarding the suitability of the part described herein for any particular purpose, and Pasternack does not assume any liability arising out of the use of any part or documentation.

PE91432 CAD Drawing

SSMC Jack to SSMC Jack Bulkhead Mount Adapter

NOTES:
CONTACT AND INSULATOR MUST WITHSTAND
2 LBS PUSH FORCE WITHOUT MOVING.

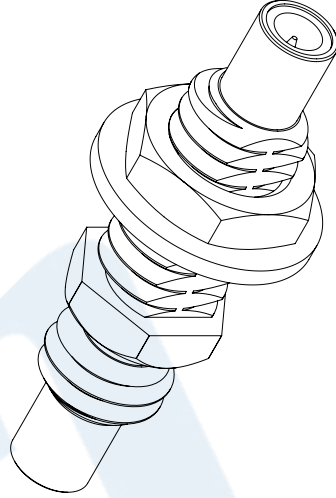
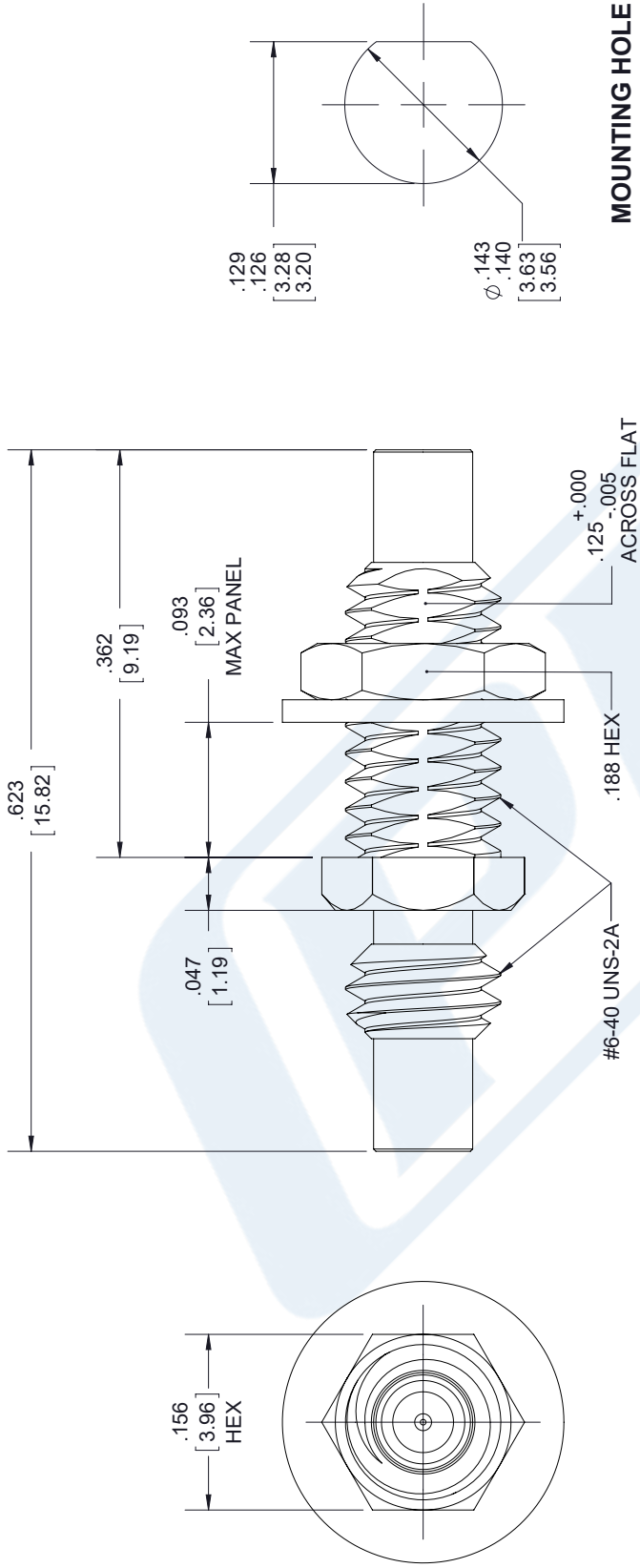

STANDARD TOLERANCES

.X ±0.2
.XX ±0.01
.XXX ±0.005

*STANDARD TOLERANCES APPLY
ONLY TO DIMENSIONS IN INCHES



Pasternack Enterprises, Inc.
P.O. Box 16759 | Irvine | CA | 92623
Phone: (949) 261-1920 | Fax: (949) 261-7451
Website: www.pasternack.com | E-Mail: sales@pasternack.com

DWG TITLE

PE91432

CAGE CODE 53919

NOTES:
1. UNLESS OTHERWISE SPECIFIED ALL DIMENSIONS ARE NOMINAL.
2. ALL SPECIFICATIONS ARE SUBJECT TO CHANGE WITHOUT NOTICE AT ANY TIME
3. DIMENSIONS ARE IN INCHES [mm].

CAD FILE 080217

SCALE N/A

SIZE A

9999