



## 7/16 DIN Male to 4.1/9.5 Mini DIN Female Adapter IP67 Mated

### TECHNICAL DATA SHEET

PE91207

#### Configuration

|                |                         |
|----------------|-------------------------|
| Connector 1    | 7/16 DIN Male           |
| Impedance 1    | 50 Ohms                 |
| Connector 2    | 4.1/9.5 Mini DIN Female |
| Impedance 2    | 50 Ohms                 |
| Adapter Design | Standard                |
| Body Style     | Straight                |

#### Electrical Specifications

|                 |             |
|-----------------|-------------|
| Frequency Range | DC to 6 GHz |
| Maximum VSWR    | 1.25:1      |

##### Frequency 1

|                 |         |
|-----------------|---------|
| Frequency, GHz  | DC to 3 |
| VSWR            | 1.1:1   |
| Return Loss, dB | 26.4    |

##### Frequency 2

|                 |        |
|-----------------|--------|
| Frequency, GHz  | 3 to 4 |
| VSWR            | 1.15:1 |
| Return Loss, dB | 23.13  |

#### Mechanical Specifications

##### Size

|                 |               |
|-----------------|---------------|
| Length, in [mm] | 1.809 [45.95] |
|-----------------|---------------|

##### Connector 1

|                                      |                          |
|--------------------------------------|--------------------------|
| Type                                 | 7/16 DIN Male            |
| Inner Conductor Material and Plating | Beryllium Copper, Silver |
| Coupling Nut Material and Plating    | Brass, Tri-Metal         |
| Hex Size, mm                         | 32                       |
| Torque, ft-lbs [Nm]                  | 18.333 [24.86]           |
| Body Material and Plating            | Brass, Tri-Metal         |
| Dielectric Type                      | PTFE                     |

##### Connector 2

|                                      |                          |
|--------------------------------------|--------------------------|
| Type                                 | 4.1/9.5 Mini DIN Female  |
| Inner Conductor Material and Plating | Beryllium Copper, Silver |
| Body Material and Plating            | Brass, Tri-Metal         |
| Dielectric Type                      | PTFE                     |

#### Environmental Specifications

##### Temperature

|                 |                   |
|-----------------|-------------------|
| Operating Range | -40 to +120 deg C |
|-----------------|-------------------|

|                    |            |
|--------------------|------------|
| Ingress Protection | IP67 Mated |
|--------------------|------------|

Click the following link (or enter part number in "SEARCH" on website) to obtain additional part information including price, inventory and certifications: [7/16 DIN Male to 4.1/9.5 Mini DIN Female Adapter IP67 Mated PE91207](#)



PE91207 CAD Drawing

7/16 DIN Male to 4.1/9.5 Mini DIN Female Adapter IP67 Mated

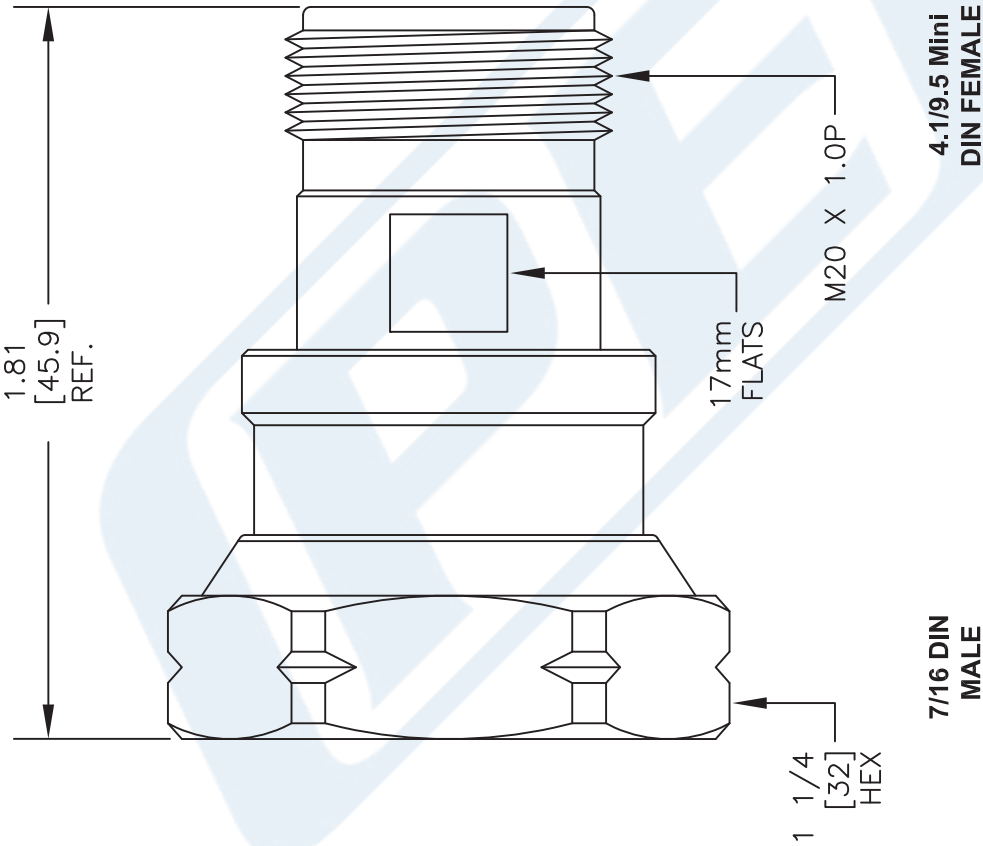

NOTES:  
1. UNLESS OTHERWISE SPECIFIED ALL DIMENSIONS ARE NOMINAL.  
2. ALL SPECIFICATIONS ARE SUBJECT TO CHANGE WITHOUT NOTICE AT ANY TIME.  
3. DIMENSIONS ARE IN INCHES [mm].

DWG TITLE  
**PE91207**

FSCM NO. 53919

2233

SIZE A

SCALE N/A

CAD FILE 060614

**PE PASTERNAK®**  
THE ENGINEER'S RF SOURCE  
Pasternack Enterprises, Inc.  
P.O. Box 16759 | Irvine | CA | 92623  
Phone: (949) 261-1920 | Fax: (949) 261-7451  
Website: www.pasternack.com | E-Mail: sales@pasternack.com