



Push-On SMP Female to SMP Female
Push-On Adapter up to 8 GHz

RF Adapters Technical Data Sheet

PE91068

Configuration

- Push-On SMP Female Connector 1
- Push-On SMP Female Connector 2
- 50 Ohms
- Straight Body Geometry

Features

- Max VSWR of 1.2:1 up to 18 GHz
- Gold Plated Beryllium Copper Contact

Applications

- General Purpose Test

Description

Pasternack's PE91068 push-on SMP female to SMP female push-on adapter is part of our full line of RF components available for same-day shipping. Our SMP to SMP adapter has a female to female gender configuration. PE91068 SMP female to SMP female adapter is gold plated and operates to 18 GHz. The Pasternack RF adapter provides excellent VSWR of 1.2:1 maximum.

RF adapters are often used to enable connections between two connector types that would otherwise not mate. Certain adapter configurations can also be used to protect connectors on expensive equipment where the number of connect/disconnect cycles is high. An RF, microwave or millimeter wave adapter is connected to the equipment, and the commonly changed connection is made with the adapter which can be easily replaced when it wears out after high usage; such adapters are referred to as connector savers. Pasternack also offers bulkhead, panel mount, hermetically sealed, reverse polarity, and isolated ground adapter varieties to serve all of your RF, microwave and millimeter wave needs.

Electrical Specifications

Description	Minimum	Typical	Maximum	Units
Frequency Range	DC		18	GHz
VSWR			1.2:1	
Insertion Loss			0.42	dB
Operating Voltage (AC)			335	Vrms
Dielectric Withstanding Voltage (AC)			500	Vrms
Insulation Resistance	5,000			MOhms

Electrical Specification Notes:
RF Leakage: -80dB to 3 GHz, -65dB to 12 GHz

Mechanical Specifications

Size	
Length	0.254 in [6.45 mm]
Width	0.135 in [3.43 mm]
Weight	0.005 lbs [2.27 g]

Click the following link (or enter part number in "SEARCH" on website) to obtain additional part information including price, inventory and certifications: [Push-On SMP Female to SMP Female Push-On Adapter up to 8 GHz PE91068](#)



Push-On SMP Female to SMP Female
Push-On Adapter up to 8 GHz

RF Adapters Technical Data Sheet

PE91068

Description	Connector 1	Connector 2
Type	SMP Female	SMP Female
Polarity	Standard	Standard

Material Specifications

Description	Connector 1		Connector 2	
	Material	Plating	Material	Plating
Type	Push-On SMP Female		Push-On SMP Female	
Contact	Beryllium Copper	Gold	Beryllium Copper	Gold
Insulation	PTFE		PTFE	
Outer Conductor	Beryllium Copper	Gold	Beryllium Copper	Gold
Body	Beryllium Copper	Gold	Beryllium Copper	Gold

Environmental Specifications

Temperature

Operating Range -65 to +165 deg C

Compliance Certifications (see [product page](#) for current document)

Plotted and Other Data

Notes:

Click the following link (or enter part number in "SEARCH" on website) to obtain additional part information including price, inventory and certifications: [Push-On SMP Female to SMP Female Push-On Adapter up to 8 GHz PE91068](#)



Push-On SMP Female to SMP Female
Push-On Adapter up to 8 GHz

RF Adapters Technical Data Sheet

PE91068

Typical Performance Data

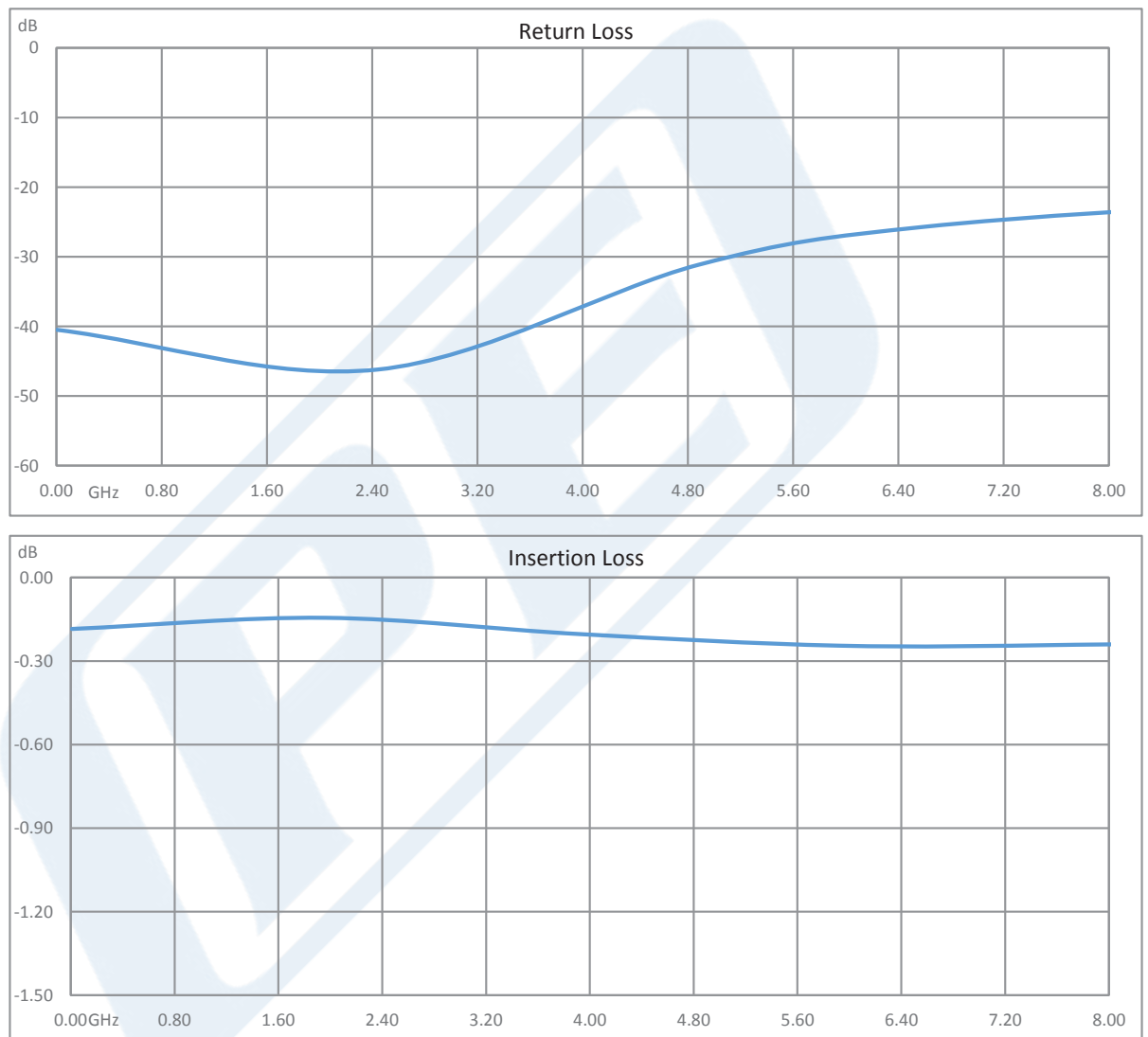

Click the following link (or enter part number in "SEARCH" on website) to obtain additional part information including price, inventory and certifications: [Push-On SMP Female to SMP Female Push-On Adapter up to 8 GHz PE91068](#)



Push-On SMP Female to SMP Female
Push-On Adapter up to 8 GHz

RF Adapters Technical Data Sheet

PE91068

Push-On SMP Female to SMP Female Push-On Adapter up to 8 GHz from Pasternack Enterprises has same day shipment for domestic and International orders. Our RF, microwave and millimeter wave products maintain a 99% availability and are part of the broadest selection in the industry.

Click the following link (or enter part number in "SEARCH" on website) to obtain additional part information including price, inventory and certifications: [Push-On SMP Female to SMP Female Push-On Adapter up to 8 GHz PE91068](https://www.pasternack.com/smp-female-smp-female-straight-adapter-pe91068-p.aspx)

URL: <https://www.pasternack.com/smp-female-smp-female-straight-adapter-pe91068-p.aspx>

The information contained in this document is accurate to the best of our knowledge and representative of the part described herein. It may be necessary to make modifications to the part and/or the documentation of the part, in order to implement improvements. Pasternack reserves the right to make such changes as required. Unless otherwise stated, all specifications are nominal. Pasternack does not make any representation or warranty regarding the suitability of the part described herein for any particular purpose, and Pasternack does not assume any liability arising out of the use of any part or documentation.

Push-On SMP Female to SMP Female Push-On Adapter up to 8 GHz

Push-On SMP Female to SMP Female Push-On Adapter up to 8 GHz

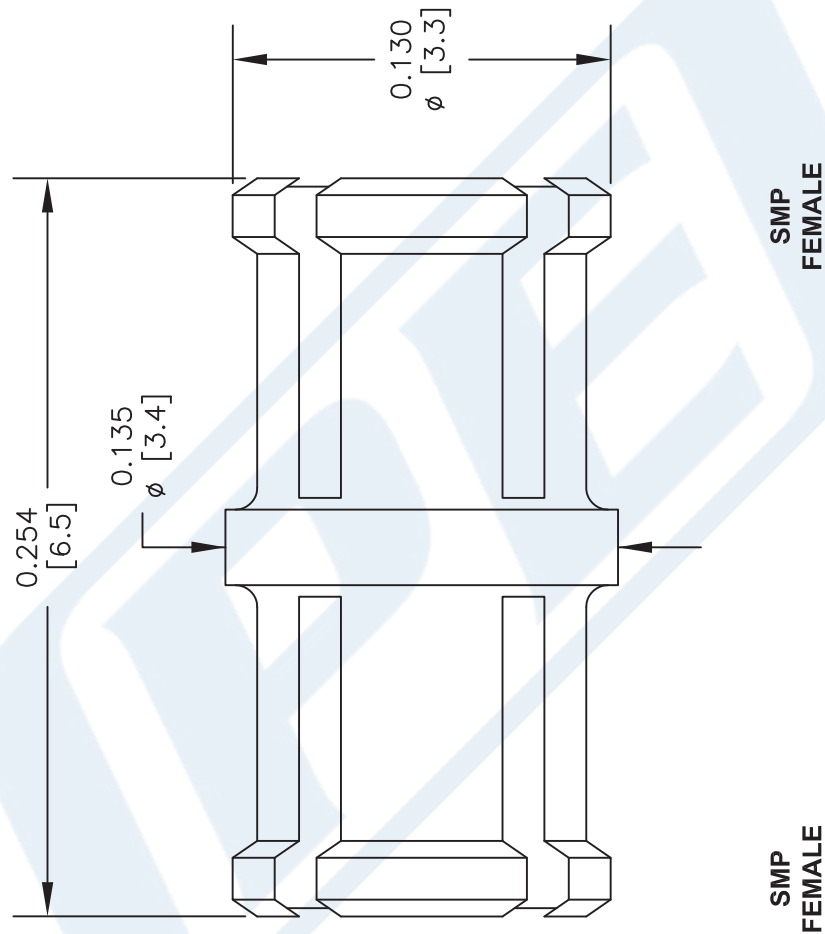

STANDARD TOLERANCES	
.X	± 0.2
.XX	± 0.1
.XXX	± 0.05

*STANDARD TOLERANCES APPLY
ONLY TO DIMENSIONS IN INCHES



Pasternack Enterprises, Inc.
P.O. Box 16759 | Irvine | CA | 92623
Phone: (949) 261-1920 | **Fax:** (949) 261-7451
Website: www.pasternack.com | **E-Mail:** sales@pasternack.com

DWG TITLE

PE91068

FSCM NO. 53919

NOTES:

1. UNLESS OTHERWISE SPECIFIED ALL DIMENSIONS ARE NOMINAL.
2. ALL SPECIFICATIONS ARE SUBJECT TO CHANGE WITHOUT NOTICE AT ANY TIME.
3. DIMENSIONS ARE IN INCHES [mm].

CAD FILE 011116

SCALE N/A

SIZE A 150