



10-32 Female Right Angle Connector Solder Attachment Thru Hole PCB, .200 inch x .067 inch Hole Spacing

RF Connectors Technical Data Sheet

PE44360

Configuration

- 10-32 Female Connector
- 50 Ohms
- Right Angle Body Geometry
- Thru Hole Interface Type
- Solder Attachment

Features

- Max. Operating Frequency 2 GHz
- Good VSWR of 1.35:1
- Gold Plated Beryllium Copper Contact
- 30 μ m minimum contact plating

Applications

- General Purpose Test
- PCB Applications

Description

Pasternack's PE44360 10-32 female right angle connector with solder attachment for thru hole PCB (.200 inch x .067 inch hole spacing) is part of our full line of RF components available for same-day shipping. Our 10-32 female connector operates up to a maximum frequency of 2 GHz and offers good VSWR of 1.35:1. Its right angle body geometry allows for easier connections in tight spaces.

Our 10-32 female right angle connector PE44360 datasheet specifications and drawing with dimensions are shown below in this PDF. Pasternack's broad catalog of RF, microwave and millimeter wave connectors allows designers to configure and customize their signal connections however they like. Whether the need is to provide an I/O for a board design, or simply create a custom cable assembly configuration, Pasternack has the right connector for the job. Pasternack can also expertly build your custom cable assemblies for you and ship same-day.

Electrical Specifications

Description	Minimum	Typical	Maximum	Units
Frequency Range	DC		2	GHz
VSWR			1.35:1	
Operating Voltage (AC)			335	Vrms

Mechanical Specifications

Size

Length	0.51 in [12.95 mm]
Width/Dia.	0.28 in [7.11 mm]
Height	0.5 in [12.7 mm]
Weight	0.013 lbs [5.9 g]

Click the following link (or enter part number in "SEARCH" on website) to obtain additional part information including price, inventory and certifications: [10-32 Female Right Angle Connector Solder Attachment Thru Hole PCB, .200 inch x .067 inch Hole Spacing PE44360](#)



10-32 Female Right Angle Connector Solder Attachment Thru Hole PCB, .200 inch x .067 inch Hole Spacing

RF Connectors Technical Data Sheet

PE44360

Material Specifications

Description	Material	Plating
Contact	Beryllium Copper	Gold 30 µin minimum
Insulation	PTFE	
Body	Brass	Nickel 100 µin minimum

Environmental Specifications

Compliance Certifications (see [product page](#) for current document)

Plotted and Other Data

Notes:

Assembly Instruction

10-32 Female Right Angle Connector Solder Attachment Thru Hole PCB, .200 inch x .067 inch Hole Spacing from Pasternack Enterprises has same day shipment for domestic and International orders. Our RF, microwave and millimeter wave products maintain a 99.4% availability and are part of the broadest selection in the industry.

Click the following link (or enter part number in "SEARCH" on website) to obtain additional part information including price, inventory and certifications: [10-32 Female Right Angle Connector Solder Attachment Thru Hole PCB, .200 inch x .067 inch Hole Spacing PE44360](#)

URL: <https://www.pasternack.com/10-32-female-standard-thru-hole-pcb-connector-pe44360-p.aspx>

The information contained in this document is accurate to the best of our knowledge and representative of the part described herein. It may be necessary to make modifications to the part and/or the documentation of the part, in order to implement improvements. Pasternack reserves the right to make such changes as required. Unless otherwise stated, all specifications are nominal. Pasternack does not make any representation or warranty regarding the suitability of the part described herein for any particular purpose, and Pasternack does not assume any liability arising out of the use of any part or documentation.

PE44360 CAD Drawing

10-32 Female Right Angle Connector Solder Attachment Thru
Hole PCB, .200 inch x .067 inch Hole Spacing

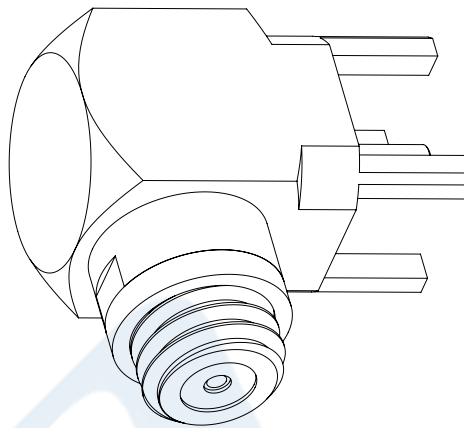
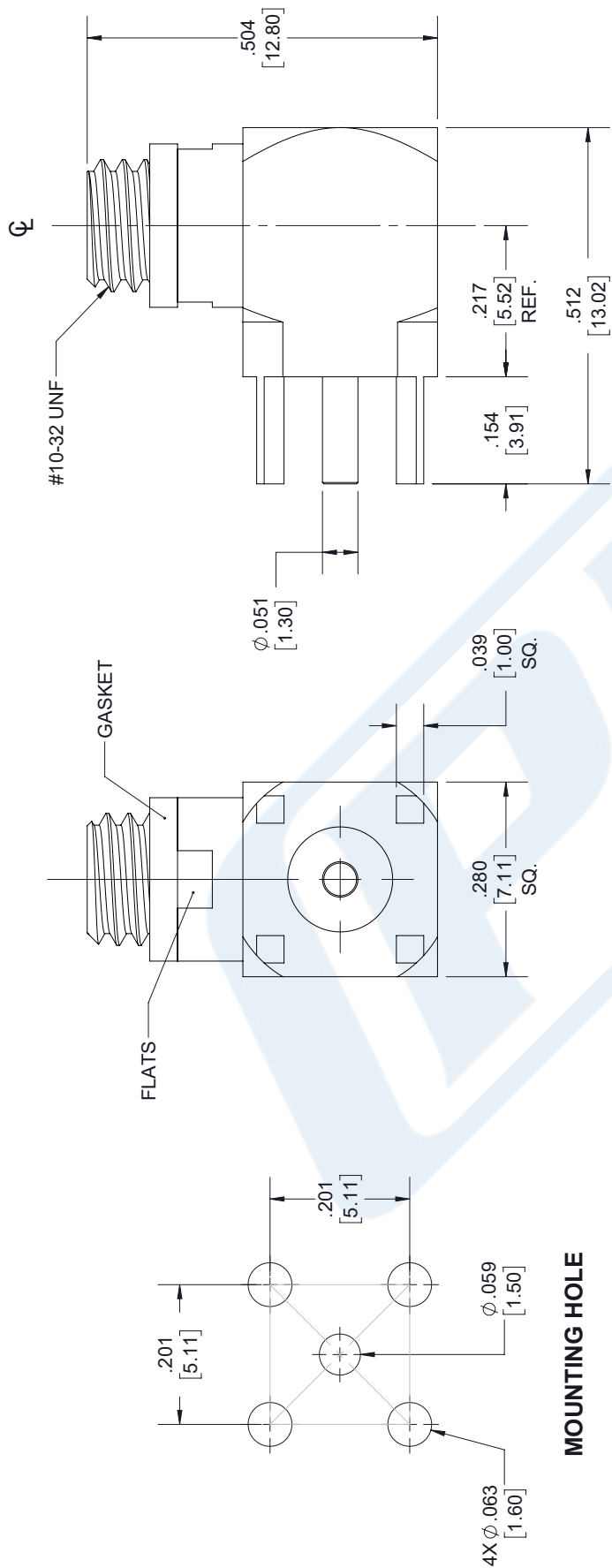

STANDARD TOLERANCES

.X ±0.2
.XX ±0.01
.XXX ±0.005

*STANDARD TOLERANCES APPLY
ONLY TO DIMENSIONS IN INCHES



Pasternack Enterprises, Inc.
P.O. Box 16759 | Irvine | CA | 92623
Phone: (949) 261-1920 | Fax: (949) 261-7451
Website: www.pasternack.com | E-Mail: sales@pasternack.com

DWG TITLE

PE44360

CAGE CODE 53919

CAD FILE 05/23/18

SCALE N/A

SIZE A

7361

NOTES:
1. UNLESS OTHERWISE SPECIFIED ALL DIMENSIONS ARE NOMINAL.
2. ALL SPECIFICATIONS ARE SUBJECT TO CHANGE WITHOUT NOTICE AT ANY TIME.
3. DIMENSIONS ARE IN INCHES [mm].