



SMA Female Radius Right Angle Connector Solder Attachment 4 Hole Flange Mount Solder Cup Terminal, .340 inch Hole Spacing

RF Connectors Technical Data Sheet

PE4220

Configuration

- SMA Female Connector
- MIL-STD-348
- 50 Ohms
- Radius Right Angle Body Geometry
- Solder Cup Interface Type
- Solder Attachment
- 4 Hole Flange

Features

- Max. Operating Frequency 18 GHz
- Excellent VSWR of 1.25:1
- Gold Plated Beryllium Copper Contact
- Contact plating according to MIL-G-45204

Applications

- General Purpose Test
- Rack and Panel Mount Applications

Description

Pasternack's PE4220 SMA female radius right angle 4 hole flange mount connector with solder cup terminal (.340 inch hole spacing) is part of our full line of RF components available for same-day shipping. Our SMA female connector operates up to a maximum frequency of 18 GHz and offers excellent VSWR of 1.25:1. Its radius right angle body geometry allows for easier connections in tight spaces. This SMA 4 hole flange connector allows designers to create external connections on their product enclosures, and can be used in a variety of other rack mount and panel mount applications.

Our SMA female radius right angle 4 hole flange connector PE4220 datasheet specifications and drawing with dimensions are shown below in this PDF. Pasternack's broad catalog of RF, microwave and millimeter wave connectors allows designers to configure and customize their signal connections however they like. Whether the need is to provide an I/O for a board design, or simply create a custom cable assembly configuration, Pasternack has the right connector for the job. Pasternack can also expertly build your custom cable assemblies for you and ship same-day.

Electrical Specifications

Description	Minimum	Typical	Maximum	Units
Frequency Range	DC		18	GHz
VSWR			1.25:1	

Mechanical Specifications

Size	
Length	0.613 in [15.57 mm]
Width/Dia.	0.5 in [12.70 mm]
Height	0.71 in [18.03 mm]
Weight	0.013 lbs [5.9 g]

Click the following link (or enter part number in "SEARCH" on website) to obtain additional part information including price, inventory and certifications: [SMA Female Radius Right Angle Connector Solder Attachment 4 Hole Flange Mount Solder Cup Terminal, .340 inch Hole Spacing PE4220](#)

PE4220

PE4220 CAD Drawing

SMA Female Radius Right Angle Connector Solder Attachment 4 Hole
Flange Mount Solder Cup Terminal, .340 inch Hole Spacing

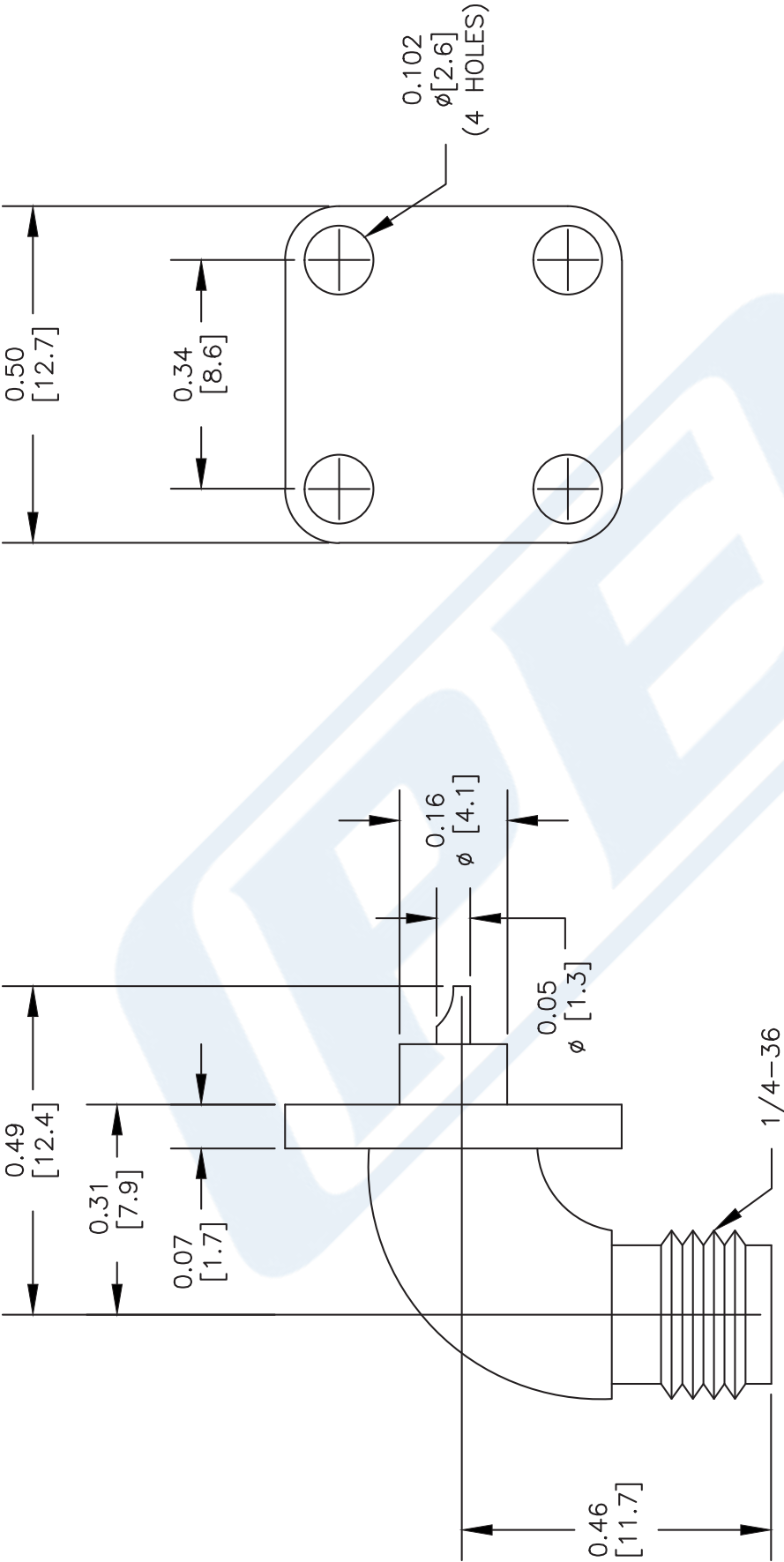

NOTES:
1. UNLESS OTHERWISE SPECIFIED ALL DIMENSIONS ARE NOMINAL.
2. ALL SPECIFICATIONS ARE SUBJECT TO CHANGE WITHOUT NOTICE AT ANY TIME.
3. DIMENSIONS ARE IN INCHES [mm].
4. FITS MIL-C-17 AND EQUIVALENT CABLES.

DWG TITLE
PE4220

FSCM NO. 53919

CAD FILE 042309
SCALE N/A
SIZE A
2233

PASTERNACK®
Pasternack Enterprises, Inc.
P.O. Box 16759 | Irvine | CA | 92623
Phone: (949) 261-1920 | Fax: (949) 261-7451
Website: www.pasternack.com | E-Mail: sales@pasternack.com